



Dawning 269

The Dawning is a different type of plan that focuses on space and open plan lifestyle. The living areas are designed to take advantage of any aspect and this plan can be flipped over to ensure that all the living areas enjoy the best aspect over every season of the year. This plan also positions the garages at the rear so that the front façade is both stylish and unique. This plan would also suit a rural residential block.

Specifications

Living:	199.3m ²
Garage:	39.6m ²
Patio:	18.8m ²
Alfresco:	12.1m ²
TOTAL AREA:	269.8m²

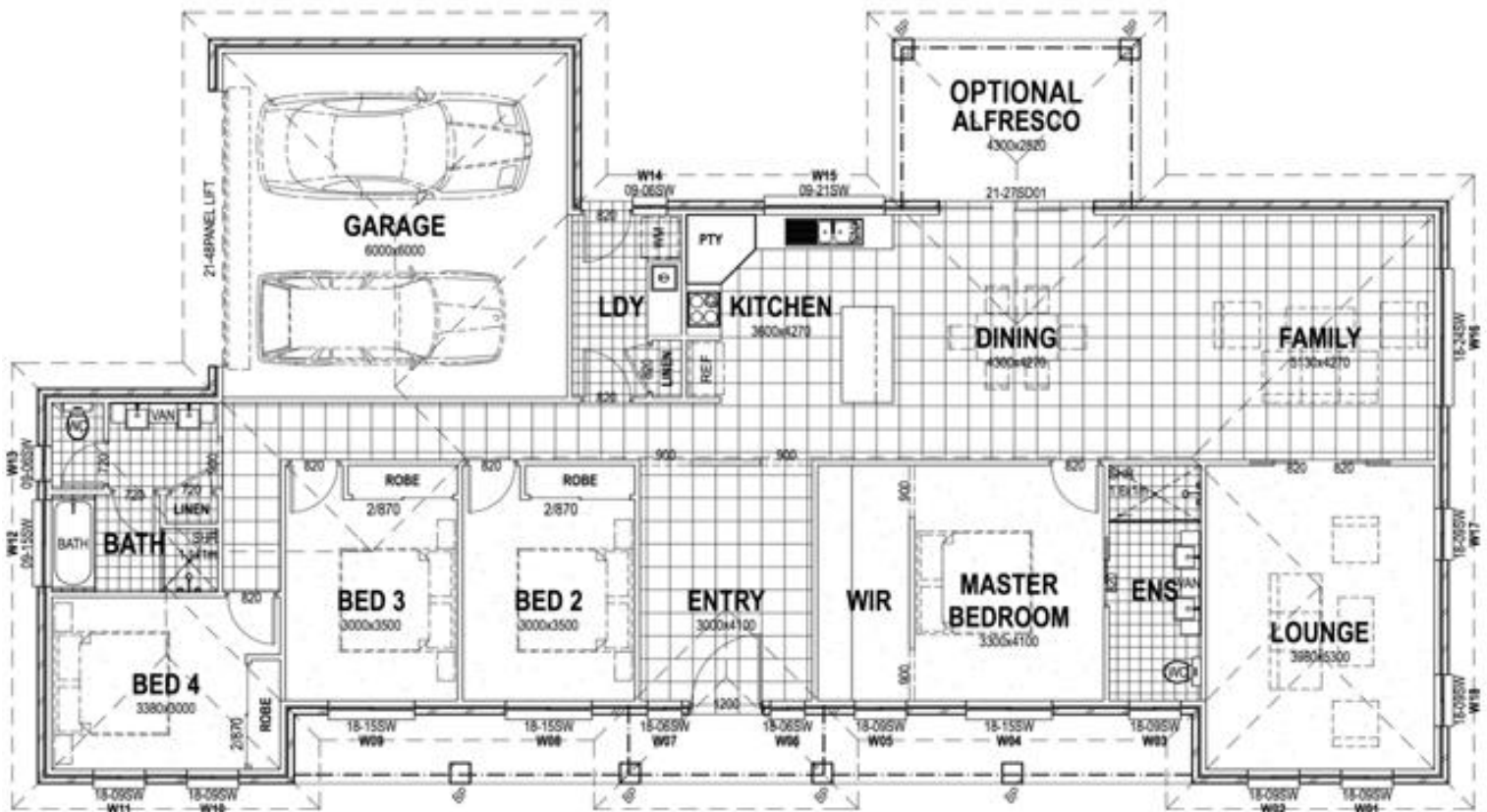

Your dream home at an affordable price

wjmhomes.com

(02) 6762 6860

wjmhomes@bigpond.com